



Centrifugal Pumps (High Capacity)

CONTACT US

Phone: 310-830-6601

FAX: 310-830-9336

Email: info@sepor.com
& services@sepor.com

LOCATIONS

WEST COAST

718 N. Fries Avenue
Wilmington, CA 90744

EAST COAST

3740 NW 124th Ave
Coral Springs, FL 33065



Features:

- Standard NEMA 56J motors
- Bronze volute, Electroless Nickel Plated volute, CPVC molded volute, or Stainless-Steel Volute and Bracket
- Compact size
- Mechanical seal: 5/8" Type 6 Buna, carbon vs. ceramic standard.

catalog Number	Model	Pump Size (inches)	Impeller Size	HP	Max Flow	Max Head
030A-071	A100-SS	1 x 1-1/2	4.39"	1 1/2	67 GPM @ 43ft. H2O	82ft.
030A-072	A100-SS	1 x 1-1/2	5.39"	3	83 GPM @ 70 ft. H2O	125ft.
030A-073	B150-SS	1-1/2 x 2	5.62"	5	160 GPM @ 65 ft. H2O	130ft.
030A-074	B200-SS	2 x 3	5.62"	7 1/2	280 GPM @ 45 ft. H2O	118ft.
030A-075	C200-SS	2 x 3	5.81"	10	300 GPM @ 60 ft. H2O	137ft.

Model CD Centrifugal Pumps Horizontal & Vertical



Description

The CD100 Series of centrifugal pumps are economical pumps for pumping liquids or slurries containing solids with particle size less than 0.15" (3.8 mm). Depending upon the TDH, pump capacities range from 12 GPM (1" x 1-1/4") to 160 GPM (1-1/2" x 2"). These pumps feature a mechanical seal of buna rubber and come in cast iron or SS construction.

Materials:

- 316 Stainless Steel
- Cast Iron
- All Bronze
- Cast Iron/Bronze Fitted Impeller

Applications:

- Industry—Chemical process, deionized water, wastewater treatment, hot solvents, and caustics
- O.E.M. – Washers, filters, chillers, cooling towers, scrubbers, plating equipment
- Agriculture—Acid fertilizers and other agricultural chemicals

Features:

- Close Coupled design using standard NEMA 56C motors.
- Optional power frame available
- Mechanical seal: John Crane 5/8" Type 21 Fluorocarbon standard, Type 9 PTFE and Type 21 Fluorocarbon double seal available
- Optional seal face materials and elastomers available
- Seal flush and seal quench optional

Catalog Number	Pump Model	Discharge/Suction (in)	Pump Speed (RPM)	GPM @ TDH	TDH (ft)	Motor HP
030A-170	CD-100	1"/1-1/4"	1750	30	18	1/2
030A-172	CD-100	1"/1-1/4"	3450	60	72	2
030A-174	CD-150	1-1/2" x 2"	1750	60	18	1/2
030A-176	CD-150	1-1/2" x 2"	3450	120	72	5

Type X Centrifugal Pumps

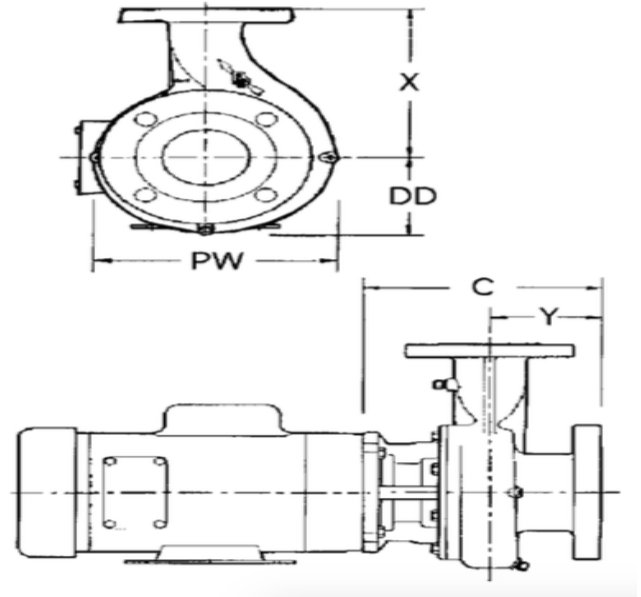

Description:

XL100 / XL100V Discharge 1", Suction 1-1/2" ANSI Flanges

XL150 / XL150V Discharge 1-1/2", Suction 3" ANSI Flanges

XL200 / XL200V Discharge 2", Suction 3" ANSI Flanges

STANDARD FEATURES

- 150 lb. centerline ANSI dimensioned flanges standard
- Available NPI connections
- Close coupled through 30 hp.
- Wide range of seal options, type 21 Viton standard
- Standard NEMA JM motors
- Replaceable shaft sleeve
- Back pull-out design
- ODP, TEFC, XP motors

Pump Model	C	DD	PW	X	Y
030A-200	8 1/4	4 1/16	8	6 1/2"	4"
030A-210	8 1/4	4 3/8	8 3/8	6 1/2"	4"
030A-220	8 5/8	5 1/16	10 1/16	6 1/2"	4"
030A-030	8 5/8	5 1/16	10 1/16	6 1/2"	4"